

The image shows the exterior of Chilton Primary School. A large tree with green leaves is in the foreground on the left. The school building is made of red brick and features a colorful canopy with red, blue, and green beams. A grey door with a sign above it that says "School Hall" is visible. To the right, there is a green directional sign with arrows pointing left, right, and up, and a circular logo on the wall. The text "FUNDRAISING FOR" is overlaid in white, bold, sans-serif font.

FUNDRAISING FOR

CHILTON

YOUR LOCAL PRIMARY SCHOOL



LEARN WITH PASSION TO
LIVE WITH PURPOSE





LET'S MAKE A DIFFERENCE - TOGETHER

Our school works hard to enrich and empower our pupils to dream big.

We are currently fundraising to provide better playground facilities and an all weather outdoor classroom, that will benefit the whole school during outdoor playtimes, enrich outdoor learning and develop better SEND opportunities within our expanding pupil intake.

But we need your help...



OUR HISTORY

Originally built for children of the UKAERE staff, Chilton Primary School sits on the boundary of Harwell Campus. It has a history dating back to before 1868, with an early National School likely preceding the current primary school.

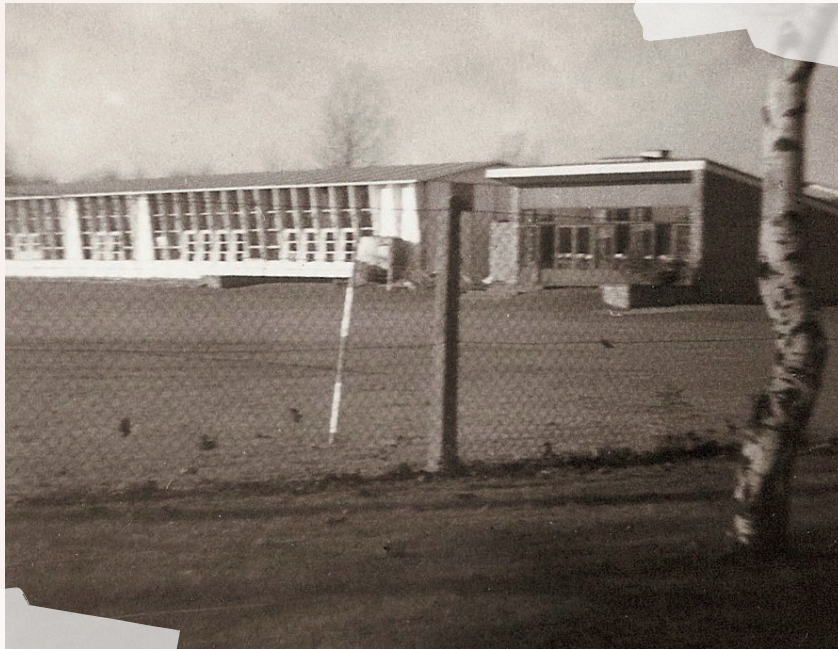

Chilton County's modern building on its current site was established in 1953, and it was rebuilt and developed again in 2001.

With the ever expanding and exciting draw of Harwell Campus, Chilton school has experienced a significant influx of residents and students since recently expanding to accommodate one and a half intakes per year group. We now have over 300 pupils.



OUR PROJECT

The school is in desperate need of an upgraded play area where the current wooden stage has been demolished due to safety risks and an old wooden play castle has long since rotted, leaving unsightly and dangerous wooden posts in a loose gravel pit.



We have been in consultation with various playground providers and now have a design which, along with the school business manager, head and school council (pupils) we are all really excited to move forward with.

The final design chosen is in partnership with Timotay Playscapes.

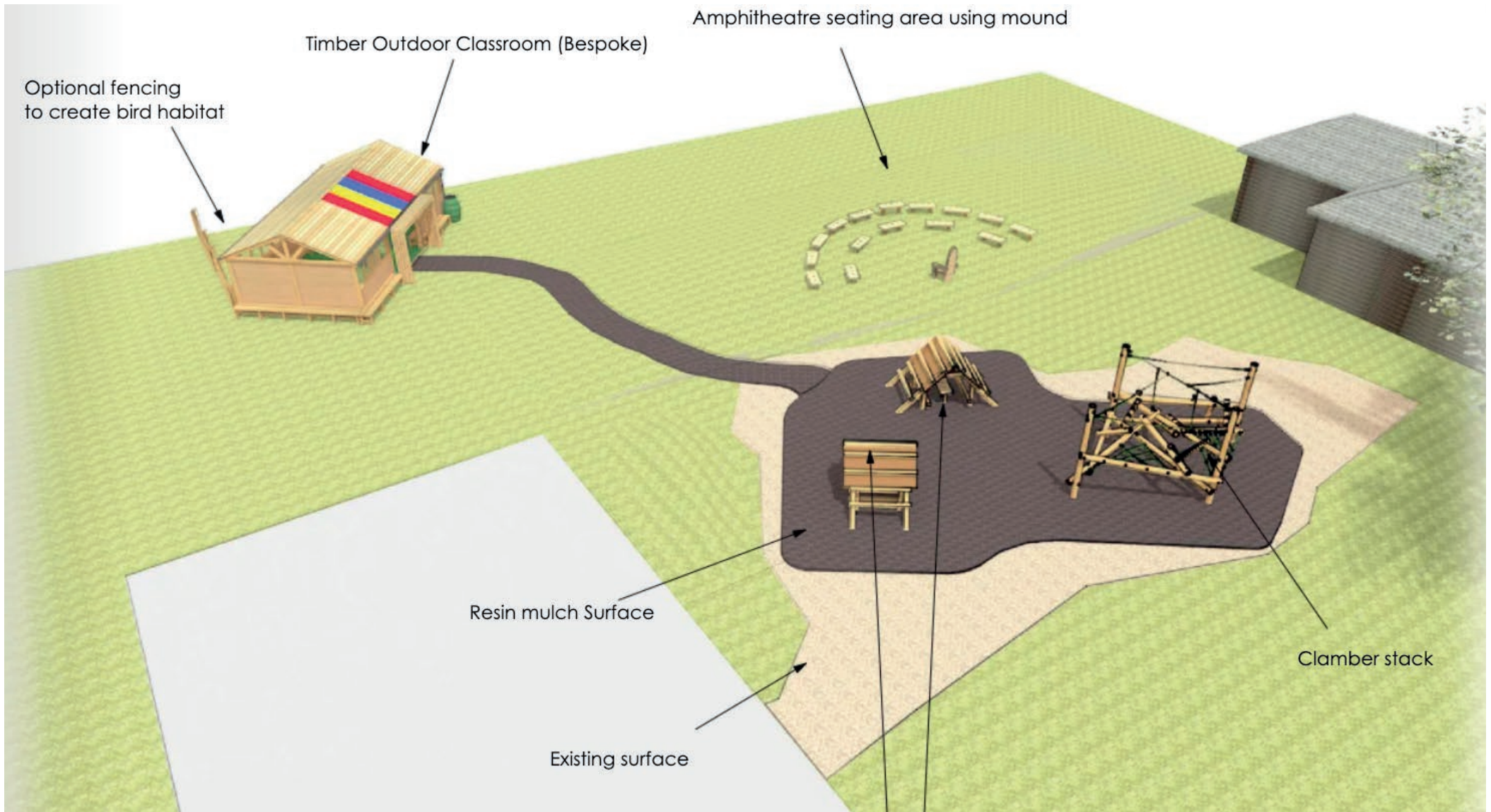

OUR NEW DESIGN
By Timotay Playscapes

An all weather outdoor classroom with seating and wild area. New pathway and surfacing to cover the loose stone area, two up and over den's to inspire

imaginary play, a clamber stack for upper body strength and encourage physical play and the headteacher's favourite, a storytelling chair.

WHY WE NEED YOU

The fundraising for this project is currently down to the Chilton School PTA.

The PTA are a group of parent volunteers who relentlessly fundraise for the school with various in-school activities and larger community events such as: the Summer fair, Christmas fair and the popular Chilton Scarecrow Trail.

Although passionate, we are a small group and there is only so much we can ask our school community to donate. Without the support of local businesses, like yourselves, it would take years to reach our fundraising target.

OPPORTUNITY TO MAKE A HUGE DIFFERENCE IN YOUR LOCAL AREA

We are asking all our neighbouring businesses at Harwell Campus and local area to JOIN FORCES TOGETHER and support us in anyway possible. If we work together we can raise the money needed to make this project happen and start making a real difference to the pupils of Chilton School.

If each business gave even a small amount, we would be able to quickly reach our target without relentless fundraising and knockbacks from government funding, who usually give to larger community projects.

Your donation will make an immediate difference to wellbeing at Chilton School and the local community. All money will go towards benefiting our local children.



HOW WILL IT BENEFIT YOU?

Investing in a new playground for the local primary school is a powerful way for businesses to give back to their community and build lasting relationships.

A vibrant, well-equipped playground will enhance the wellbeing and development of local children and strengthen community ties, creating a positive social impact that reflects well on supporting businesses.

Many staff members live locally and have children attending the school, meaning the benefits of this investment extend directly to employees and their families. Enhancing the local offer will also attract new skilled workers to the area.

Supporting education and community spaces can help uplift the local economy over time, fostering a healthier, more connected community that ultimately benefits everyone, including local businesses.

Finally, we are looking to involve local press to promote and report on the new playground, with the inclusion of thanks to those wonderful businesses who have supported us along the way.

WE HAVE THREE LEVELS OF SPONSORSHIP AVAILABLE

Any donation towards our new classroom and outdoor playground will make a HUGE difference to support our ongoing fundraising.

If you would like to donate towards this project you can use our crowdfunder page

www.crowdfunder.co.uk/p/chilton-pta

or contact ChiltonOxonPTA@gmail.com for more details.

You can also sponsor a specific item of play equipment. You can see these on the following pages.

1. HEADLINE SPONSOR
for the outdoor classroom

2. GENERAL SPONSOR
A straight donation, or to sponsor a certain piece of equipment

3. MATCH FUNDING



OUTDOOR CLASSROOM £35,000

The outdoor classroom is the largest part of the project and is responsible for the main bulk of our fundraising. It also would make the biggest difference to the school.

This incredible building will vastly improve outdoor learning and SEND opportunities within Chilton School.

If you feel you would like to sponsor this specific part of the project, we would love to engrave your company name on the building, promoting local community spirit and hero'ing your incredible generosity for future generations to see and enjoy.

To discuss this incredible opportunity please contact Jenny & Freya directly on ChiltonOxonPTA@gmail.com

CLAMBER STACK

£7,469.61

The Clamber stack fills a much needed gap in the outdoor play equipment at Chilton School.

This popular play item provides children with the challenge of negotiating this maze of inter-weaving timber and rope.

Learning aims include:

- Physical development
- Negotiate change of height
 - Balancing
- Self-esteem and self confidence
 - Problem solving

Designs by
Timotay Playscapes

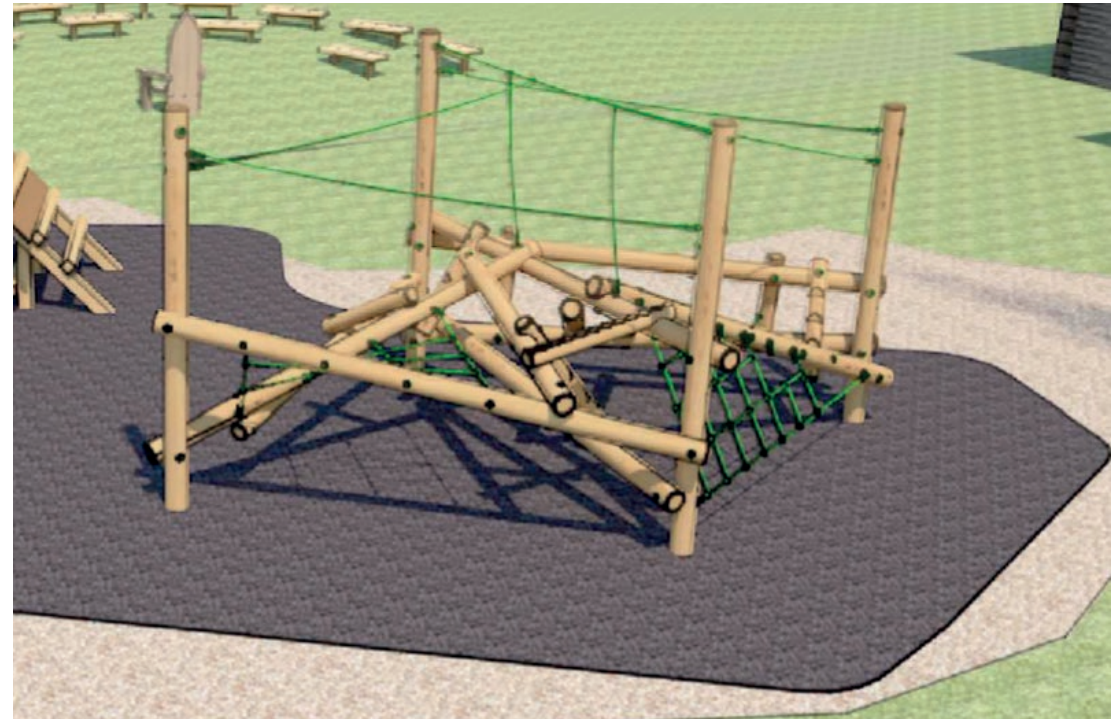

UP & OVER DENS

£3,973.14 each

We have two Up & Over Dens within the final playground design.

Imaginative play is crucial for a child's development, fostering skills in areas like social interaction, emotional regulation, and cognitive growth. It provides a safe space for children to explore emotions, practice social skills, and develop creative thinking abilities.

Imaginative play plays an important role in helping Children of all ages understand the World - there are many studies proving this available including Chris Athey's Theory of Schemas.

Designs by
Timotay Playscapes

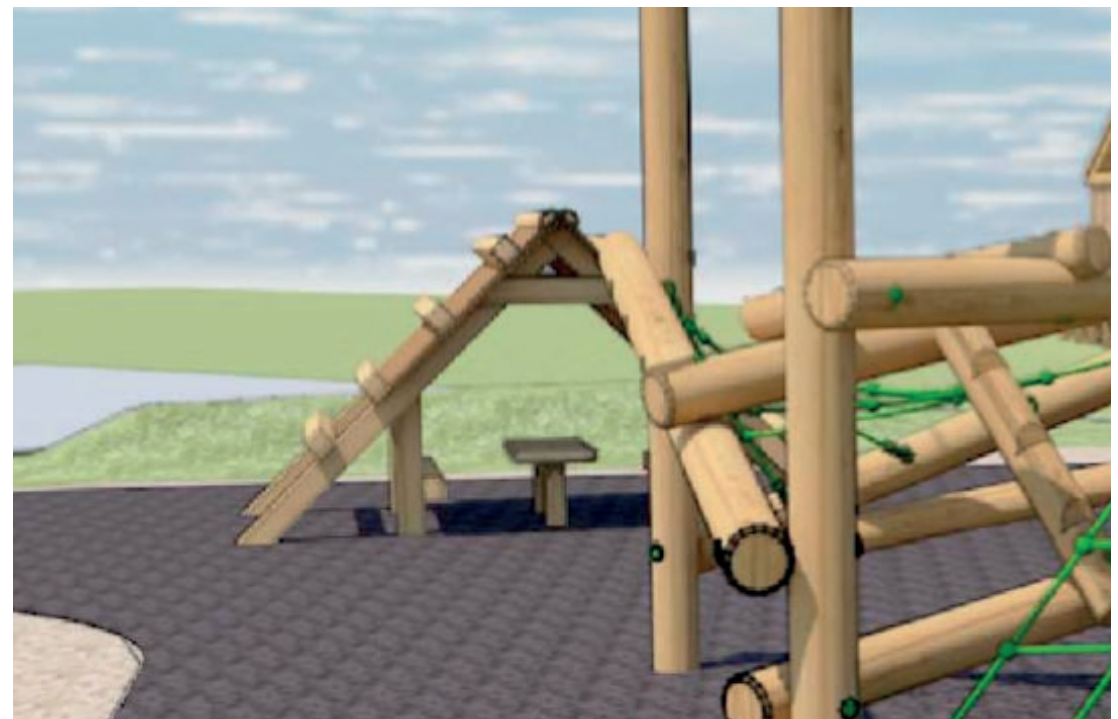
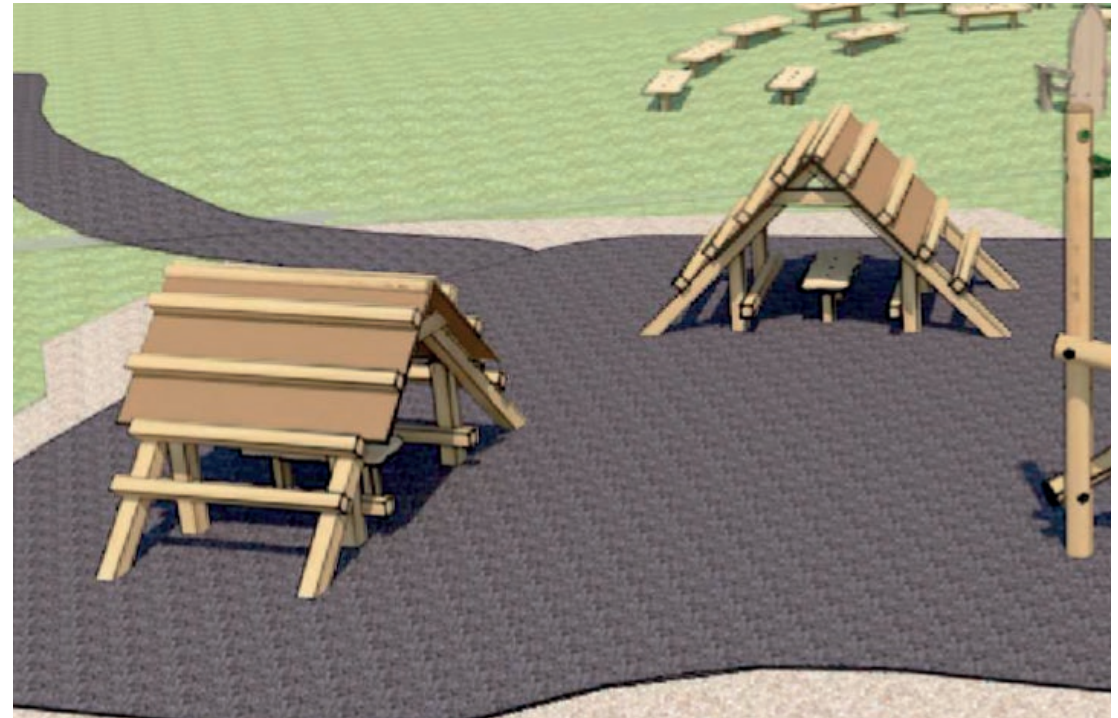

STORYTELLING CHAIR

£400

ADDITIONAL SEATING

£4000

An outdoor storytelling area at Chilton School will help foster a love of reading and storytelling, while also nurturing language and communication skills. It encourages creativity, imagination, and active listening.

Storytelling chairs create a designated, engaging space for pupils to share their own stories or listen to others, promoting social interaction and a sense of community.

This will likely be a phase 2 installment.

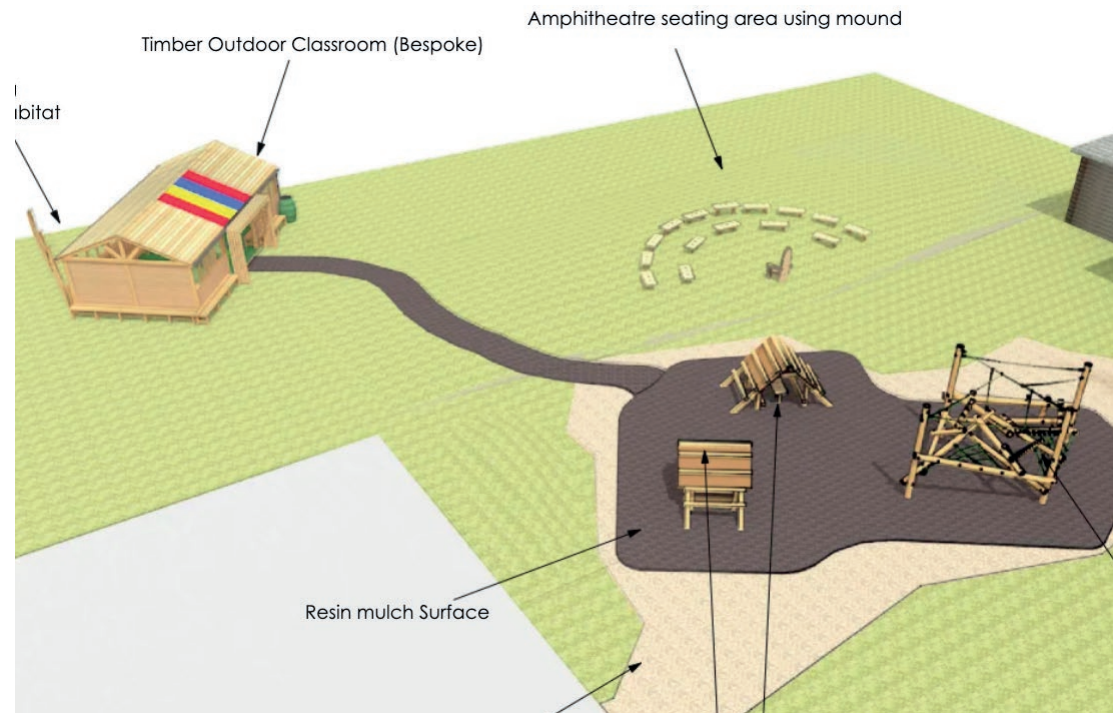

MATCH FUNDING

The PTA are tirelessly fundraising.

Our best events make between £2000 and £5000 with smaller events making a few hundred.

If you are able to match fund any of these events please get in touch, we would be truly grateful.

Recent PTA events
& fundraising amounts:

Sponsored Marathon Event	£ 6,300
Christmas Fair	£ 2,448
Easter Bingo	£326
Class Discos	£512
World Book Day Wonka Bars	£458





CROWDFUNDER PAGE

www.crowdfunder.co.uk/p/chilton-pta



Donating via crowdfunder allows us to receive additional Gift Aid. We can also then apply for their Extra+ Funding grants. You can donate as a one off, or set up a regular donation if you are able.

THE IMPORTANCE OF OUTDOOR LEARNING

It is widely known and proven that outdoor learning is crucial for holistic development, offering benefits like improved physical health and mental wellbeing, enhanced cognitive function, and stronger social-emotional skills. It fosters a love for nature, reduces stress, and promotes mental well-being. Outdoor learning also provides unique opportunities for exploration, discovery, and engaging with the natural world in a way that indoor settings cannot.



**CHILTON
SCHOOL PTA**



JENNY BILLINGS

Co Chair

Mum of 2 at Chilton.

Key Stage one Primary school teacher and local tutor with 10 years experience in Key Stage Two.



FREYA DEABILL

Co Chair

Mum of 2 at Chilton. Graphic Designer. The School library is named after Martin Fishenden, Freya's grandpa who worked as Head of Administration on Harwell Site for over 40 years.



JANE HEYDENRYCH

Treasurer

Mum of 2 at Chilton.

Educational Engagement Officer at Didcot Railway Centre. Previously a primary school teacher of 12 years.



Document created by Chilton County PTA - Oxfordshire
Registered Charity number - 1049882

ChiltonOxonPTA@gmail.com

Crowdfunder: www.crowdfunder.co.uk/p/chilton-pta

Chilton County Primary School, Downside, Chilton, Didcot OX11 0PQ

Image Credits: Chilton School, Unsplash, northdrive.wordpress.com and Timotay Playscapes

The image shows the exterior of a brick building with a modern architectural style. Large, multi-paned windows with dark frames are prominent on the left. A covered walkway with a metal railing and a glass-paneled roof extends along the building. In the background, a tiled roof and a glass entrance are visible, with several people walking. The scene is brightly lit, suggesting a sunny day.

THANK YOU